

# Parts and Accessories

Available from the Scelzi Equipment Parts Store  
2645 Cherry Street, Fresno, CA. 93706

Call toll-free 800-858-2883



Gas Shocks



Key and Lock Replacements



Lights and Light Packages



Water Cask Holders



Vise Stands



And much more....



Wood or Steel Stakes and Beds

**WE DO BODY REPAIR**  
Don't have the time to fix it yourself? Let our trained Truck Body Experts do that job for you! Call us for estimates



Cranes and Crane Parts for AutoCrane and others



**Scelzi Enterprises, Inc.**

Premium Truck Bodies Since 1979

1-800-858-2883

www.SEINC.com

Pool Locations:

California (2) • Oregon • Washington • Colorado

Form SL-031 (6/2021)

# Truck Body Owner's Manual

Including Maintenance Schedule and Warranty



## Landscaper, Chipper, and Dump Bodies



**SCELZI ENTERPRISES, INC • PREMIUM TRUCK BODIES**

# Thank You for Purchasing a SCELZI Truck Body!

You have purchased a Scelzi Enterprises Truck Body, the top-of-the-line work truck body in the USA. We began business operations in 1979 in Fresno, California. Today we have multiple production and assembly locations around the USA, and dealerships from coast to coast. Since our first day we insisted on building the highest quality truck bodies anywhere, and that fanatical attention to detail and craftsmanship continues to this day. If you have any problems with your truck body, please contact us or your dealer immediately. And Thank You again for purchasing a Scelzi!

## Table of Contents

*Reading Your Nameplate.....pg 3*  
*Warranty Registration .....pg 3*  
*Limited Warranty .....pg 4*  
*Recommended Maintenance.....pg 7*  
*Maintenance Records/Checklist .....pg 10*  
*Spare Parts .....pg 12*

## Recording Your Scelzi Truck Body Details

Truck Body Model Number: \_\_\_\_\_

Body Serial Number : \_\_\_\_\_

Date Purchased: \_\_\_\_\_

## Reading Your Nameplate

Your Scelzi Model Number and Serial Number (and additional information) are required for Warranty Registration. This information can be found on your truck body Nameplate.



## Warranty Registration

Please register your warranty for fastest response and to receive updates and Special Offers. You may use the Registration Form that was supplied to you when you received delivery of your truck body or you may complete the Online Registration Form located at [www. https://www.seinc.com/warranty](https://www.seinc.com/warranty). Or scan the QR code below to proceed directly to that online form.



# LIMITED WARRANTY

## *What is Covered under the Warranty?*

- All Scelzi installed Signature Series Body ~ 3 Year Warranty or 36,000 miles
- Scelzi installed Crown Series Body ~ 3 Year Warranty or 36,000 miles
- All Scelzi installed Flatbed, Western Flatbed, Contractor Bodies, Chipper Bodies, Landscaper Body, Dump Bodies, and Water Trucks ~ 1 Year Warranty or 12,000 miles
- All Scelzi installed Flatbeds and Contractor Bodies with Aluminum Flooring ~ 2 Year Warranty or 24,000 miles

Scelzi Enterprises, Inc., (“Scelzi”) upon installation, warrants each product to be free from defects in material, workmanship and rust-through or corrosion from the date of purchase. Scelzi warrants its factory applied topcoat against material defects for a three (3) year or 36,000 mile period, two (2) year or 24,000 miles or one (1) year or 12,000 miles (depending on the body type referred to above) whichever occurs first from the date of purchase. This Warranty applies only when the Product is properly installed by Scelzi or by an authorized Scelzi installer, properly maintained and used for the purpose for which it was designed.

## *Who benefits from the Warranty?*

Scelzi’s obligation under this Warranty automatically applies to the original purchaser of the Product. Subsequent owners must register the product with Scelzi to reinstate the remaining warranty coverage period at no charge. This warranty does not extend to, or include, dealer trade transactions.

## *How is a warranty claim handled?*

The purchaser shall immediately notify Scelzi Enterprises, Inc. of any claim under this Warranty by calling the Warranty Department at 800-858-2883. The purchaser must have the following information available: date of purchase, product model, serial numbers and chassis vehicle identification number. The purchaser must provide a detailed description of the alleged defect including photographs of the specific defect and pictures of the complete unit. All repairs must be authorized in writing by Scelzi prior to any work being performed. If the purchaser initiates any work without such written authorization, this Warranty shall be void and of no force and effect.

### **THERE ARE NO EXCEPTIONS TO THIS PROVISION!**

If, after inspection, Scelzi determines the Product is defective in material or workmanship as claimed, Scelzi shall have the option to repair the defect and/or to replace the Product, at Scelzi’s sole and absolute discretion. Labor required to repair defective material or workmanship will be covered for the period specified above depending on the body type purchased

(excludes wood material). Scelzi shall not be liable for additional costs to the purchase, including, but not limited to, any labor cost for installation, removal, or reinstallation of any defective Product to or from the vehicle, for any transportation cost, and/or for any rental reimbursement, loss of vehicle use, inconvenience, storage, lost time/pay.

Purchaser shall prepay all freight charges for returning the Product to Scelzi, or any other location designated by Scelzi, and for receiving the returned product. All warranties are VOID if any repair, replacement or body swap is not completed pursuant to this Warranty by Scelzi or Scelzi authorized installers. Any Warranty work shall be F.O.B. Scelzi or Scelzi authorized installers.

## *What are the exclusions to the warranty?*

This warranty shall not apply to:

1. Accessories or service not furnished by Scelzi or damage/corrosion caused by such accessories or services, including but not limited to, optional parts, aftermarket products, components, installation, finish painting, lettering, wiring or modifications.
2. Damage or corrosion, including surface rust, due to normal wear and tear such as stone chips, chemical treatments and exposure due to airborne contaminants/pollutants.
3. Damage due to accident, misuse, abuse, or alteration.
4. Product(s) purchased and used outside the USA and Canada.
5. Product(s) not properly maintained per maintenance instructions.
6. Labor for wood floors and wood side racks that are found defective within the first year.
7. All add-on attachments not manufactured by Scelzi and all modifications and alterations not performed by Scelzi.
8. Accessory products that are included in a customer order but not manufactured by Scelzi (i.e. cranes, aerial lifts, liftgates, generators, etc.) are covered by accessory product manufacturer’s warranty in effect at the time of delivery and is subject to the terms of such Manufacturer’s Warranty. Purchaser is advised that such Warranty may only cover product and not labor. In some cases, Scelzi will not undertake the warranty until the Manufacture has determined if the item is under Manufacturer’s warranty. Scelzi will only honor Manufacturer’s warranty.
9. Paint or decals required following repairs or replacement of parts under warranty after one year from date the warranty period begins.
10. Products which have been misused, abused, or damaged, including but not limited to, accidents.
11. Fatigue cracking of the body structure caused by overloading, severe off-road applications, twisting loads induced by cranes or aerial devices or similar events.



12. Specific non-rust through and paint warranty exclusions:
  - a) Products which have been used to carry corrosive materials result in rust-through conditions.
  - b) Products purchased by the first owner/user in prime paint.
  - c) Products being warranted under the no rust-through warranty must have a hole rusted through the metal.
  - d) Rust on painted surfaces is not considered rust-through.
  - e) Paint deterioration caused by chemical reactions including, but not limited to acid rain, industrial fallout or improper cleaning materials.
13. Products not properly maintained per Operator's Manual.
14. No alignments after body install.
15. Under NO CIRCUMSTANCES, whether in contract, tort, or otherwise, shall Scelzi Enterprises, Inc. or its Affiliates' and Subsidiaries' or their Respective Directors', Officers', Employees' or Agents' (HEREINAFTER COLLECTIVELY "SCELZI") total liability arising in connection with the sale exceed the amount of any sales or other proceeds received by Scelzi pursuant to any contract of sale or purchase orders.
16. Under NO CIRCUMSTANCES, whether in contract, tort, or otherwise shall Scelzi be liable for liquidated, special, indirect, incidental, exemplary, or consequential damages, expenses, or costs, including without limitation, lost profits, howsoever caused and even if the potential of such damages was disclosed and/or known.
17. Scelzi hereby disclaims and excludes and other express, implied, or statutory warranties, arising by operation of law or otherwise, including without limitation, any warranties or merchantability and fitness for a particular purpose.

### DISCLAIMERS

Scelzi warrants its Products only as stated in this Warranty. Scelzi makes no other warranties, express or implied, and disclaims all other warranties, including any implied warranty of merchantability or fitness for any particular purpose.

Scelzi's obligations are limited to those expressed in this Warranty, and Scelzi shall not be liable to the purchaser or any third party for any direct or indirect, incidental or consequential damage or loss.

If any Product is improperly installed, altered, misused, damaged, or otherwise tampered with, the foregoing Warranty shall be void and of no force or effect. This Warranty shall be enforced and construed in accordance with the laws of California.

***No person is authorized to modify or add to the foregoing Warranty.***

## ONBOARD MODULE PROGRAMMING

Scelzi Enterprises is not responsible for any cost that may be accrued due to onboard modules that must be flashed or programmed, by the dealership, due to the installation of a Scelzi body. This includes but is not limited to erratic tail light operation, backup camera programming, and any other factory programs that must be added or removed for proper operation with a Scelzi body.

### GATE CHAINS

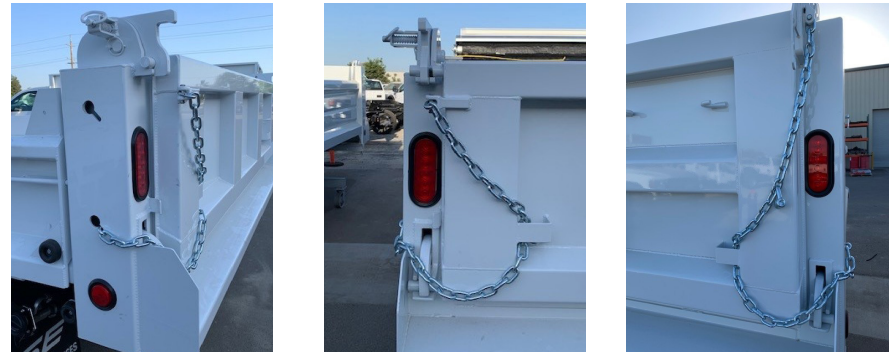

Gate chains can be utilized when using the spreader on the dump body. This helps control the speed and amount of material being dumped.

## RECOMMENDED MAINTENANCE

**Care must be exercised when using solvents or cleansing solutions to clean the body. Some solvents/solutions may cause paint damage that may void the Warranty.**

### DAILY

Power Take-Off (PTO) - Check all air, hydraulic, and working mechanisms before operating PTO.

### MONTHLY

Inspect PTO for possible leaks and tighten all air, hydraulic, and mounting hardware if necessary.



### EVERY 3 MONTHS

**TIGHTEN MOUNTING HARDWARE.** Check and tighten ALL body mounting hardware once every three months. This includes:

- Body Mount bolts
- Hitch Mount bolts

**LUBRICATE SUBFRAME AND HOIST.** The fittings shown in the diagram below should be lubricated every 3 months using EP-2 Chassis Grease (or equivalent) and each time the truck is serviced.

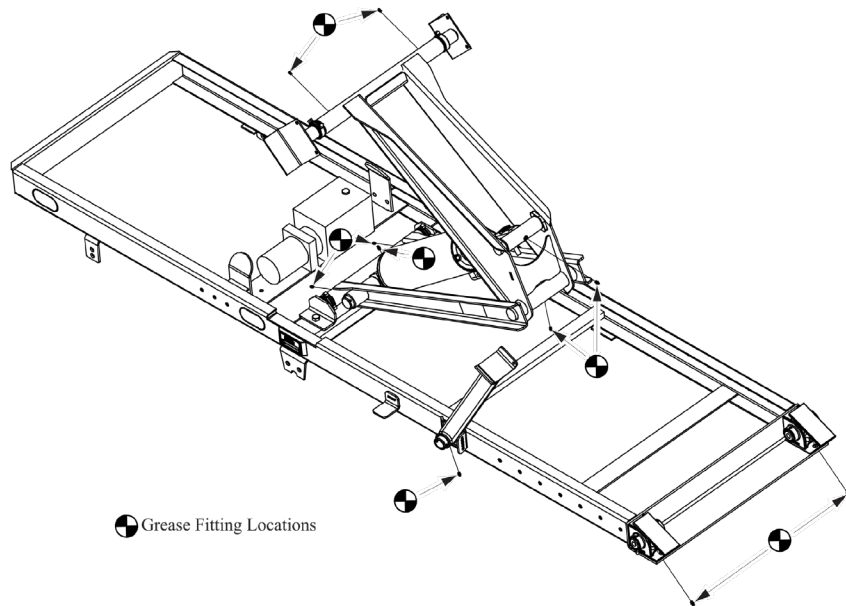

### Annually

Change the oil in the hoist reservoir using hydraulic oil.

### EVERY 6 MONTHS

**GREASE T-HANDLES:** Apply a small amount of white lithium grease to the internal and external T-handle mechanisms every 6 months.

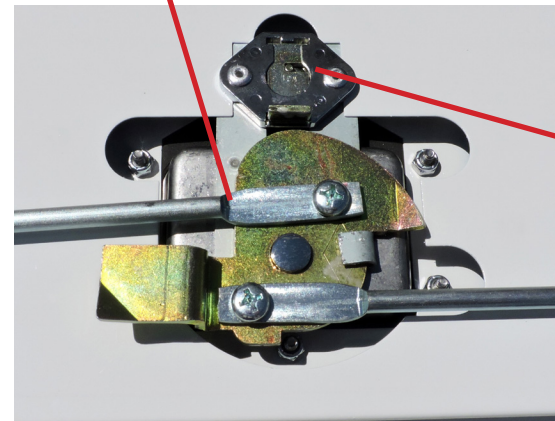
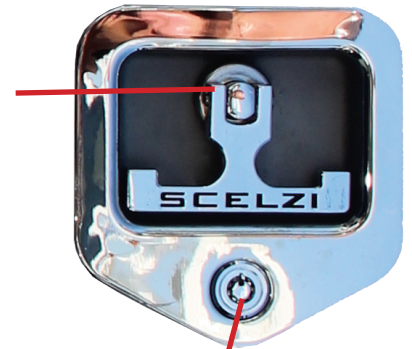

**LOCK CYLINDERS:** Apply graphite to the lock cylinders once a month on both the internal and external mechanisms.

